

LAST SAVED BY: kpatel1 21/2/25 5:23 PM

PLOTTED BY: KAJAL A. PATEL

This drawing is property of Mamta Shah & Associates. Without our prior consent, it must be neither copied nor made available to third parties for the purpose other than for which it is meant.



Total site area = 4215 Sq.m

Legends for hatch	
	Existing Brick wall masonry
	Landscape
	Proposed compound wall
	Hard Paved area
	Curb stone
	Units to be renovated

R3	22-02-25	SC/PR	GMDC	Tender	KBP
R2	01-03-24	SC/PR	GMDC	Tender	KBP
R1	27-09-23	SC/PR	GMDC	Tender	KBP
RO	11-07-23	SC/PR	GMDC	Tender	KBP
Rev	Date	Issued	Issued to	Issued for	Author

Key Plan:

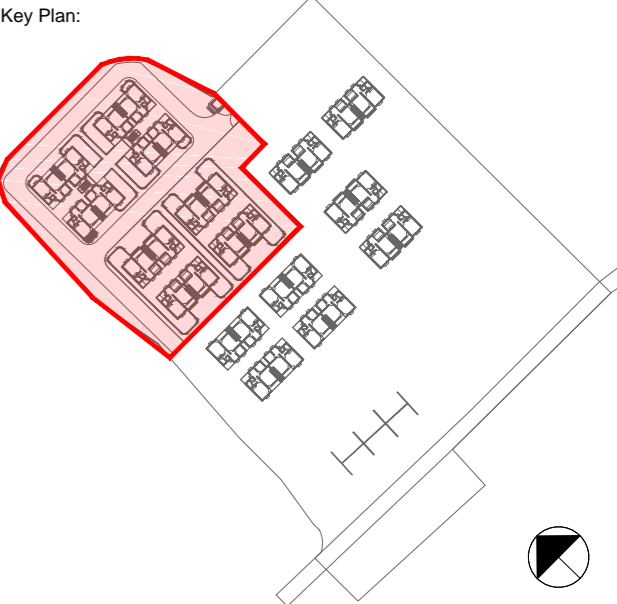

Project: GMDC Township Development

Drawing: Proposed Site Layout  
C Type Quarters

Drawing Code: 2310\_ARC\_TD\_15\_R3

Print Size: A2 Scale: 1:250

File Title: 2310\_ARC\_TD\_15\_R3

Project Code: MSA 2310	Project Type: ARC	Location: Ambaji	
Print Date: 21-Feb-25	Drawn By: K Patel	Checked By: K Patel	Approved By: M Shah

Architect: MAMTA SHAH & ASSOCIATES  
Architects & Interior Designers  
C-12, Chanakyapuri Society,  
Chanakyapuri Char Rasta,  
New Sama Road, Baroda  
Ph. No. +91 265 2712267 / 2710967  
mamta@msain.com / www.msain.com

Client: Gujarat Mineral Development Corporation